

# **PATROL AND CHUCK BOX PLANS**

Contributed by and Used with Permission by:

Carl Bylin, ASM, Troop 16

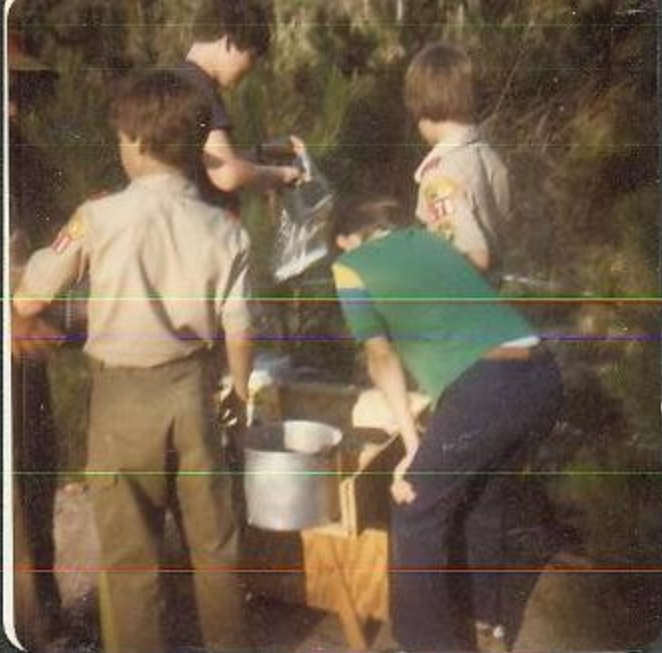





Back Top Part, shell.

TROOP 196  
PATROL  
BOX  
1976





# The TROOP 176 Patrol Box

The Troop 176 Patrol Box has been designed with two compartments. The upper compartment is clean storage; food, cooking, clothing, etc.. The lower compartment is used for tents, hatchets, shovels, and miscellaneous collections. The top is split and opens clam-shell fashion, with each half available for use as a light-duty shelf. The legs are arranged so as to double as handles from each end for carrying and are stored along the sides when not in use.

The box is made from  $\frac{3}{8}$  inch exterior grade plywood, with the finished side out. It is assembled with one inch panneling nails. These nails were selected because they are ribbed for better grip, they are very thin to prevent splitting, and they are not so long that inexperienced Scouts would have trouble nailing them straight.

In our Troop, one Father, equipped with a table or radial arm saw, pre-cut the pieces and supervised assembly by individual patrols. It is important that each joint be glued, therefore care should be taken that the pieces be smoothly and squarely cut.

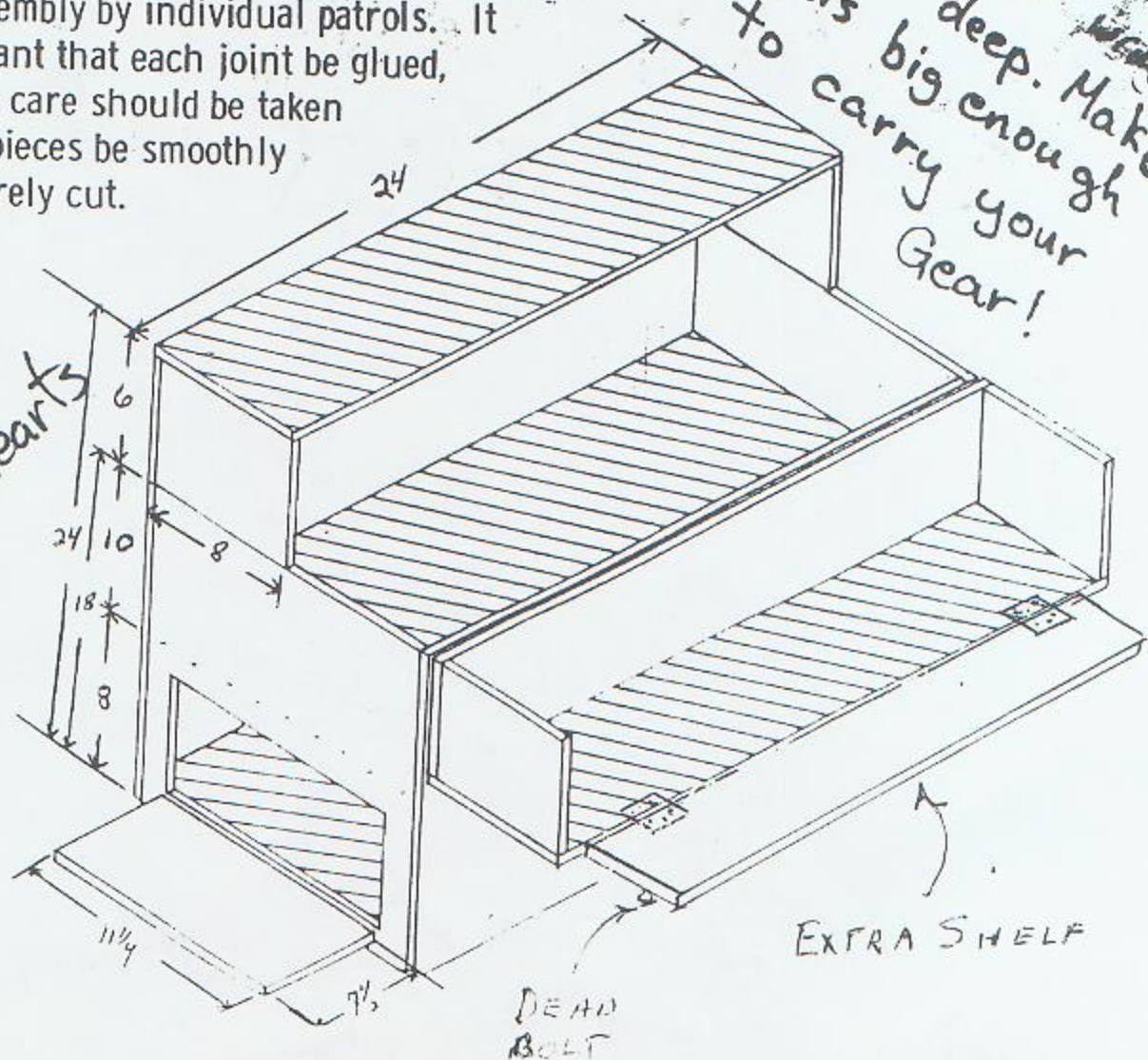



# STANDARD VIEWS EXCLUDING HARDWARE

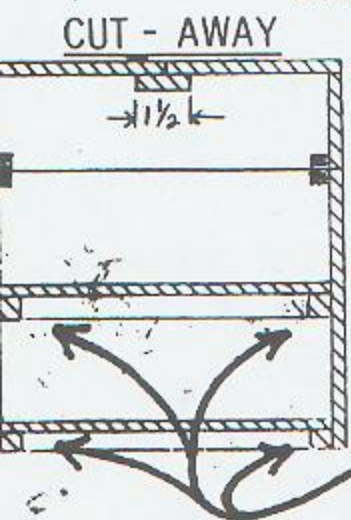
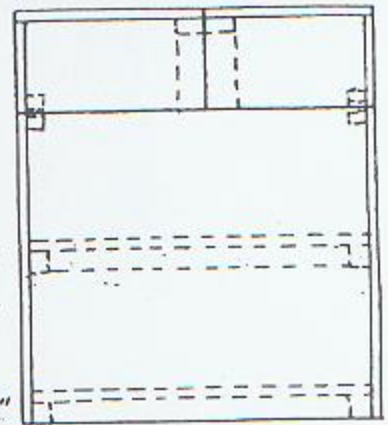
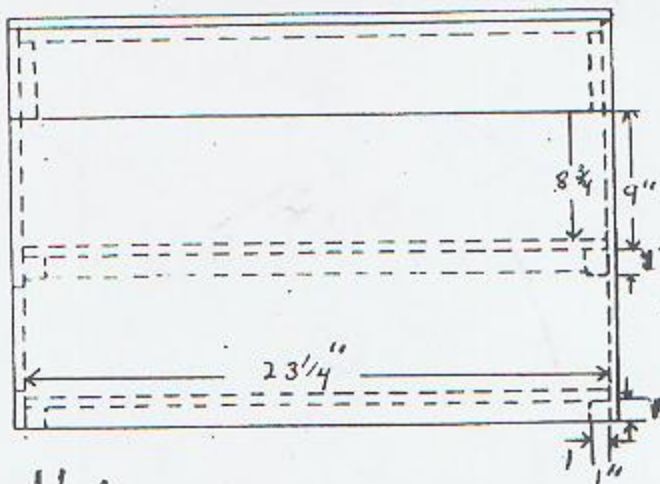
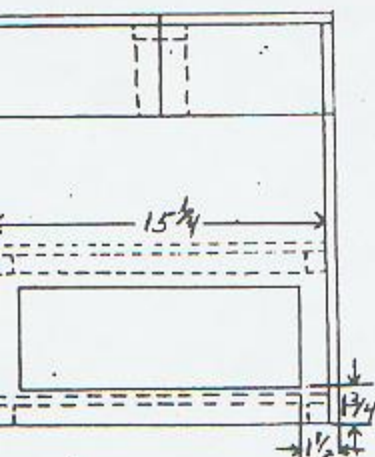

Note: 1"x1" ledges attached to sides to support shelf & bottom

LOCATION OF DEAD BOLT FOR LOWER LEVEL DOOR

Note: hole cut from shelf inside to allow bolt to pass through to door below

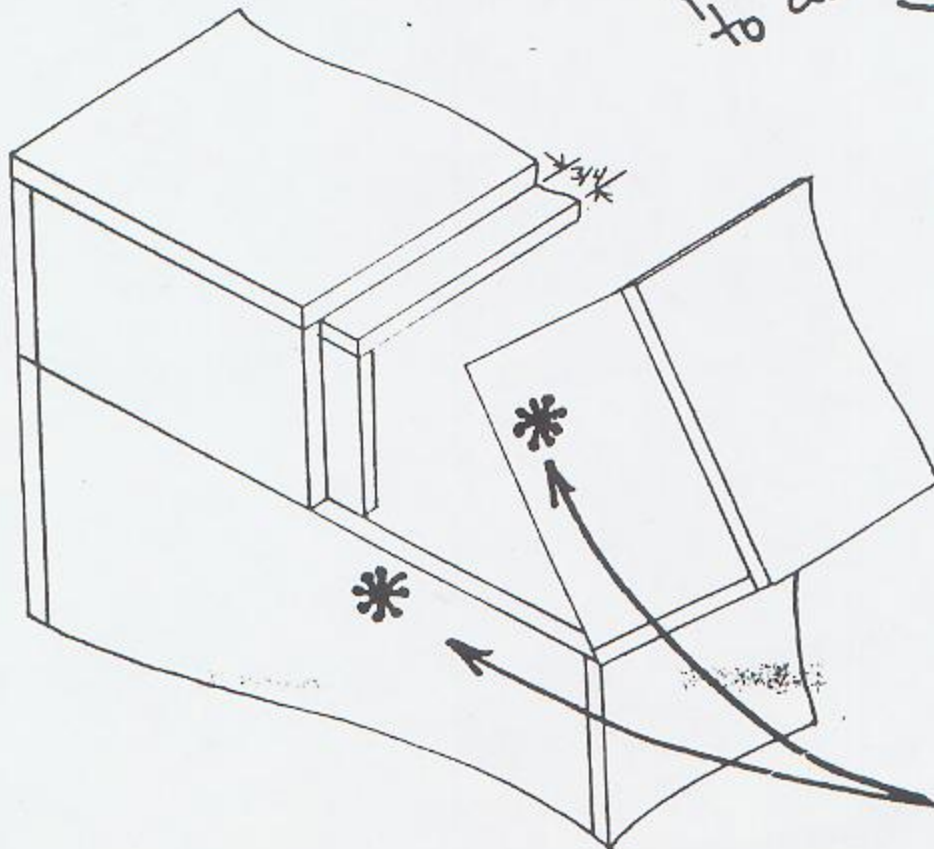
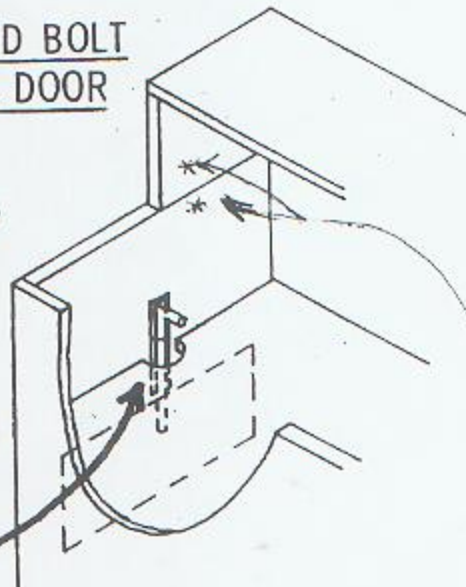

LOCKING LEDGE INSTALLED ON ONE SIDE OF LID.

Note: brass trunk latches are attached to lid half without the locking ledge





## EQUIPMENT LIST ----- TROOP 176 Patrol Box

Number	Name
1	Cabinet knob or equivalent
2	Piano hinge ; 22" or 4 3"(minimum) hinges
1	Piano hinge ; 10-3/4" or 2 2"(minimum) hinges
16	Tee nuts - 1/4"
4	Eye bolts or thumb screws - 1-1/2 x 1/4"
4	Hex bolts - 2" x 1/4"
8	Washer & nuts - 1/4"
4	Lock washer - 1/4"
2	Trunk latch
1	Dead bolt lock - at least 1.0" throw
6 oz or 1 box	Pannel nails - 1"
8 oz	Wood glue - waterproof
Optional	
4	Angle iron ( reinforcement ) [COANER BRACES]
Tube	Waterproof chalking
--	Paint

Box --- 3/8 or 1/2 " exterior Plywood

BOX --- 3/8" Plywood

Number	Size	Name	For 1/2"
2	24 x 6	Lid side	
2	24 x 8-1/2	Lid top	
4	6 x 8	Lid end	
2	24 x 18	Bottom side	
2	16 x 18	Bottom end	
2	23 x 15-7/8	Inside shelves	
4	1 x 1 x 23	Shelves support	
4	1 x 1 x 13-1/2	Shelves support	
4	1/2 x 1/2 x 22	Lid support	
1	1-1/2 x 1/2 x 23	Locking ledge - top	
2	1-1/2 x 1/2 x 5 1/2	Locking ledge - side	

Number	Size	Name
2	24 x 6	Lid side
2	24 x 8	Lid top
4	6 x 8	Lid end
2	24 x 18	Bottom side
2	18 x 16	Bottom end
2	23 1/4 x 15 1/4	Inside shelves
4	1 x 1 x 23 1/4	Ledge support
4	1 x 1 x 13 1/4	Ledge support
4	3/8 x 1/2 x 22	Lid support
1	1 1/2 x 3/8 x 23 1/4	Locking ledge
2	1 1/2 x 3/8 x 5	Locking ledge- ends

## LEGS

## LEGS

2	1-1/2 x 1/2 x 16	Legs; handles
2	1-1/2 x 1/2 x 18	Legs; handles

4	1 1/2 x 1/2 x 16	Legs, handles
---	------------------	---------------

EXTRA SHELF (need to shorten locking ledge)

2	23 x 7 1/2"
4	3" or 4" HINGE
2	DEAD BOLT
1	TRUNK LATCH













